

## Assembly recommendation EPS.EASY

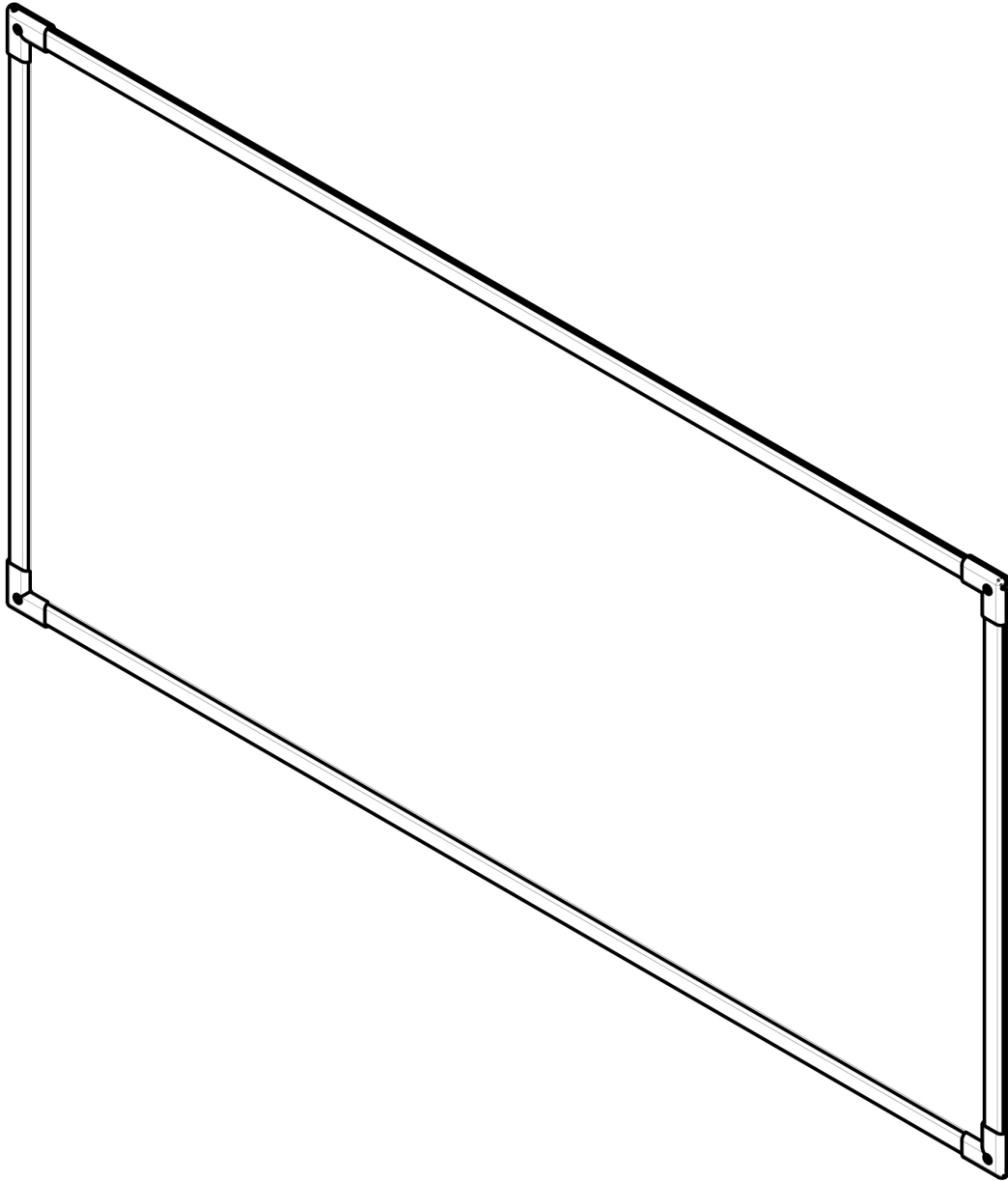

Valid for ovale keder profile  
EPS 7-001

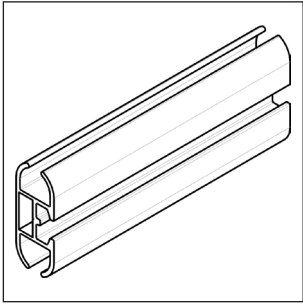

**EPS 7-001**  
Keder profile  
anodised, 16x40mm

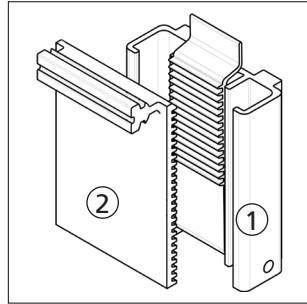

**EPS 7-080**  
EASYQUICK Wall bracket  
① Holding part  
② Connector

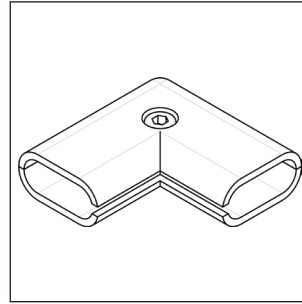

**EPS 7-070**  
Oval corner

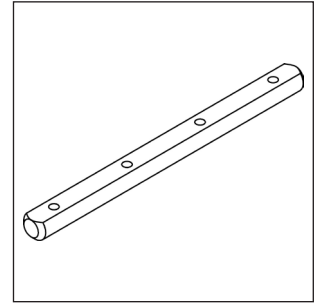

**EPS 7-060**  
Coupling piece

**1** Assembly of upper profiles

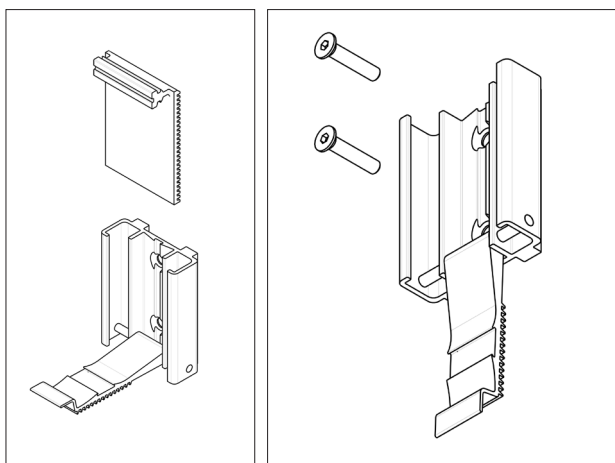

Pull the connector out of the wall bracket and fold the lock forward so that the drill holes for the EPS.EASYQUICK wall bracket can be marked.

**Distance between the EPS.EASYQUICK wall brackets according to specification.**

In the case of large fabric dimensions, the specified distance between the EPS.EASYQUICK wall mounting parts is reduced. Keep a minimum distance of approx. 500 mm to the ends of the profiles.

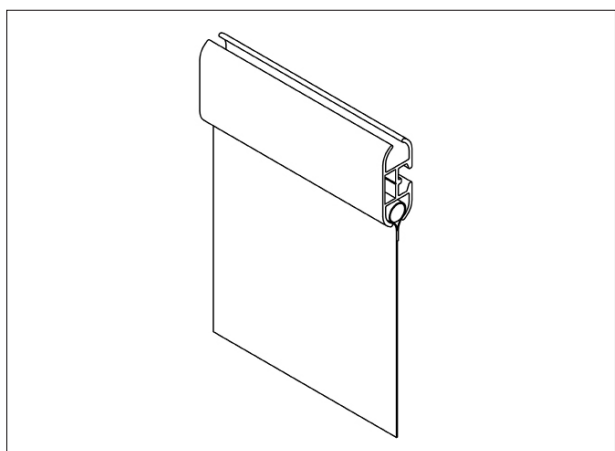

Push the upper keder of the fabric into the lower profile opening of the respective keder rail (EPS 7-001/7-005).

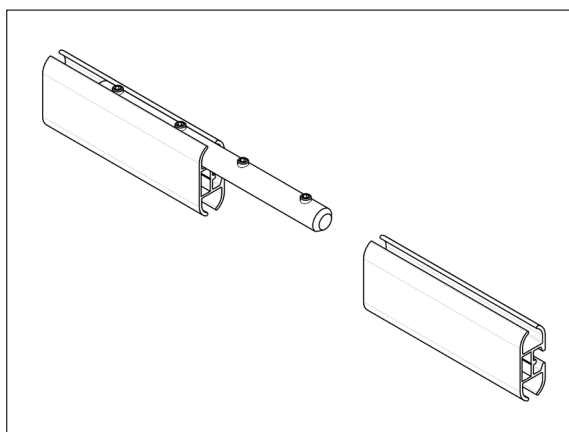

For longer dimensions, connect the keder rail with the coupling piece EPS 7-060.

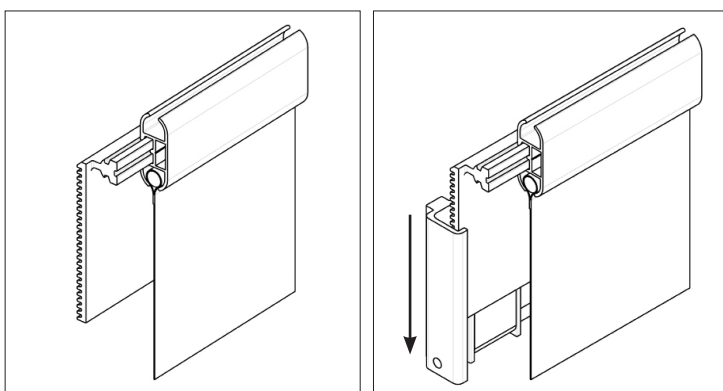

Slide all connectors into the rear channel of the respective keder rail. Insert connectors into the holding part of the EPS.EASYQUICK. To do this, press the locking device back and push in the connector flush with the upper edge of the holding part.

**2** Assembly of lower profiles

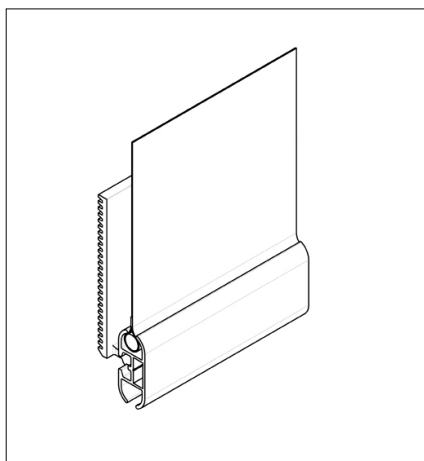

Slide the bottom keder rail over the bottom keder of the fabric. Push all connectors of the lower EPS.EASYQUICK wall brackets that are still to be installed into the rear channel of the respective keder rail.

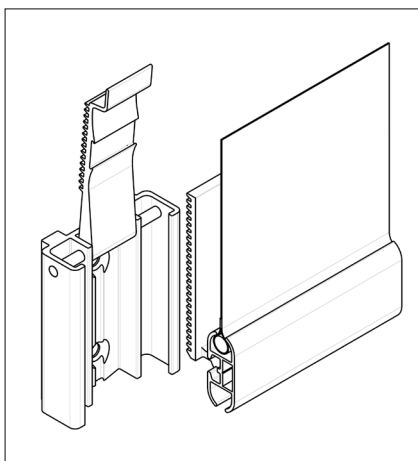

Level the connectors. To mark the drill holes, hold the wall holding part to the side next to the connector and mark the drill holes. Make sure that the connector is fully pushed in after the mounting of the holding parts.

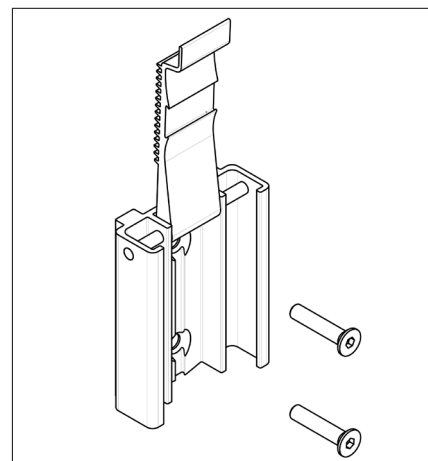

Assembly the EPS.EASYQuick holding parts

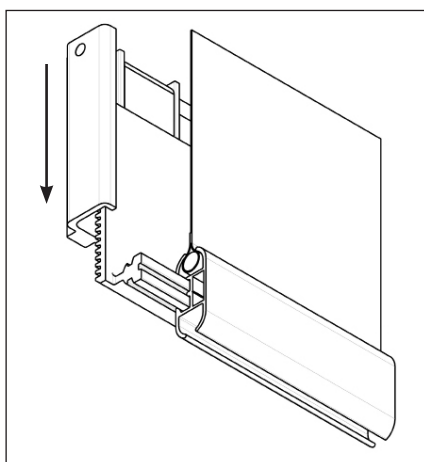

Insert the connectors into the wall brackets. To do this, press the lock back and slide in the connector from above. This slightly pre-tensions the fabric.

### 3 Assembly of the side profiles

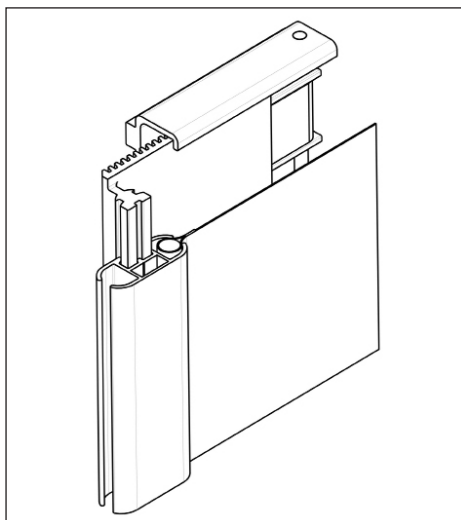

Slide the side profile rails over the side keder of the fabric and repeat the assembly process of the EPS.EASYQUICK wall bracket described above.

### 4 Tensioning of the banner on all sides

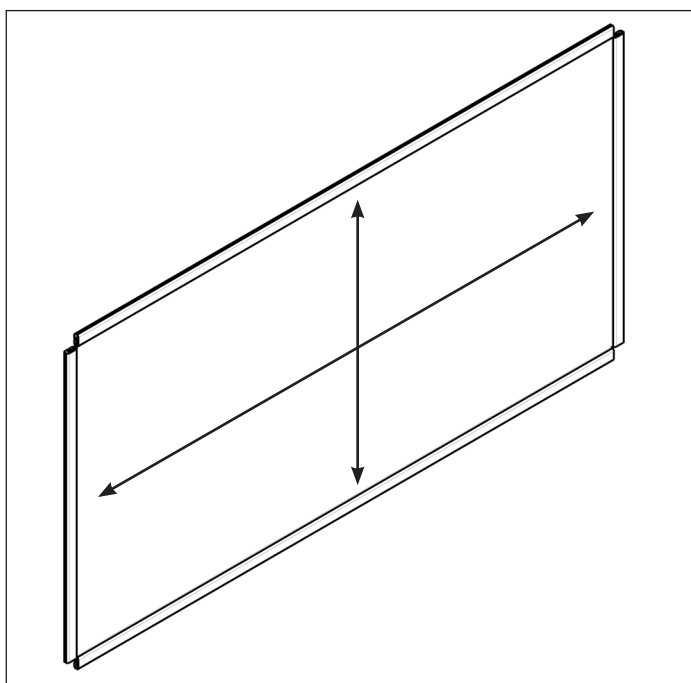

When all EPS.EASYQUICK wall brackets are mounted, the fabric can be tensioned on all four sides. To do this, the individual keder rails are pulled or pressed up/down or outwards.

Repeat this process until the keder rails are straight and all wrinkles have disappeared.

After tightening, the connectors can be pulled out of the wall mounting parts on the respective side by a maximum of 35 mm.

**5** Assembly clamping corners

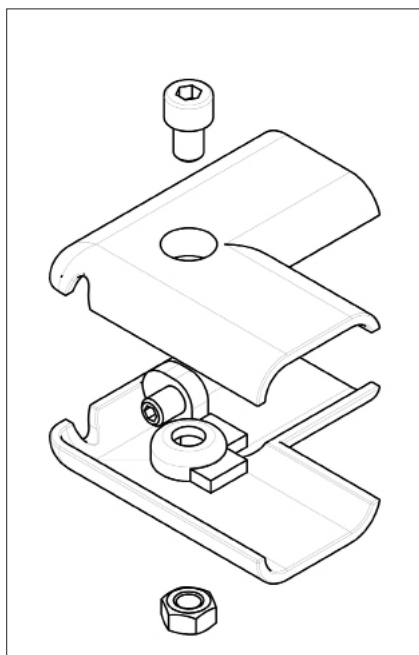

Separate the upper shell of the clamping corners from the lower shell.

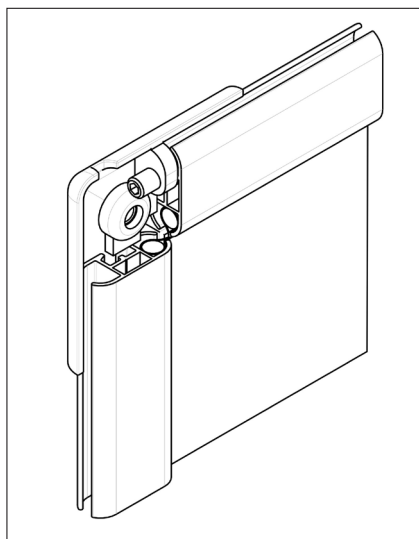

Guide the lower shell of the clamping corners to the junctions of the keder rails.

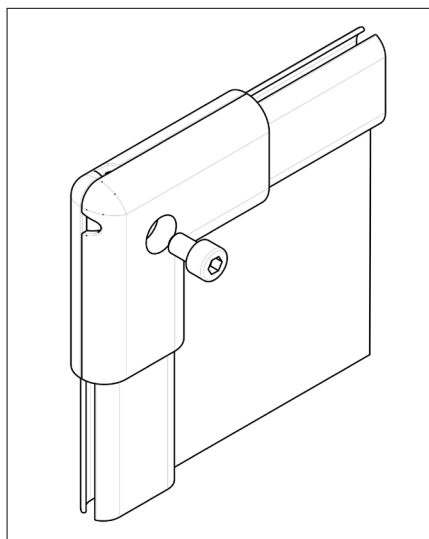

Screw the upper shell to the lower shell.  
**Note:** If necessary, turn the internal grub screw all the way back for additional tensioning.

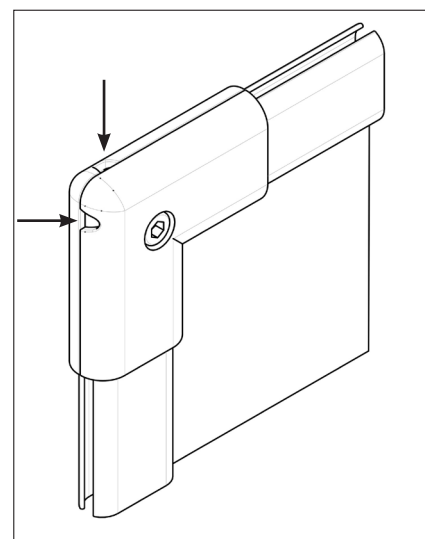

Clamp the corners by screwing in the internal grub screw. Retighten the screw connection of the upper and lower shell.

## Notes on banner assembly:

Basically, we recommend that a keder flag is sewn directly onto the banner or that a hemstitch is made up.

The initial dimension for banner production is the visible size!

**Please note:**

Frame size = visible size + 74 mm

Profile cut size = visible size - 15 mm

*We only guarantee the function of the EPS.EASYQUICK wall bracket and the tensionable corners if these installation instructions are followed exactly.*

*We cannot assume any liability for the proper and secure attachment of the EPS.EASYQUICK wall mounting parts to the various surfaces.*